

GRAND MERIDIAN

Lightweight Woodburning and Vent-Free Masonry Fireplaces



FIREPLACES
FOR BUILDERS
Fmi

Stylish extras for homeowners...Better value for builders

Modular Masonry Fireplace Systems

Today's most discriminating homeowners will settle for nothing less than a real masonry fireplace. But they soon find that the level of craftsmanship to properly build a site-built fireplace is extremely expensive, and has all but disappeared. Due to their weight and method of construction, masonry fireplaces are also very limited in where they can actually be built.

The solution to this dilemma is the new Grand Meridian from Fmi Products. The Grand Meridian is a true, 100% masonry fireplace, but with only half the weight and half the cost of traditional masonry fireplaces. This modular masonry system can easily be added to your master bedroom, upstairs retreat or even your outdoor patio, without any special engineering or major building reinforcement. The Grand Meridian allows you to realize your dream of a fireplace in your favorite spot and provide you with years of treasured memories.



Easy Installation

Easy, no mess installation means lower costs and faster completion time.



1. Installing base and first course

2. Starting the smoke chamber

3. Easy to build smoke dome

4. Finishing with the dome top

5. Finished Meridian in under 2 hours

Product Offering

Our Grand Meridian is offered as a traditional wood burning fireplace that can also accept an ANSI Z21.60 approved gas log set. We also offer this exceptional fireplace in a vent-free gas version designed for approved, indoor applications—where allowed—or for outdoor applications using a clean burning gas log set. For those looking for more design creativity, both the wood burning and gas versions are available as a 2-sided, see-thru fireplace.

Features & Benefits

- Lightweight construction with multiple firebox sizes available
- Indoor/outdoor, wood burning, natural and propane gas systems
- Approved for multi-story combustible wood floor installations
- Superior thermal efficiencies, with the highest resistance strength at 28 days
- Complies with UL 127 & UL 103 chimney component standards
- 10-year limited warranty

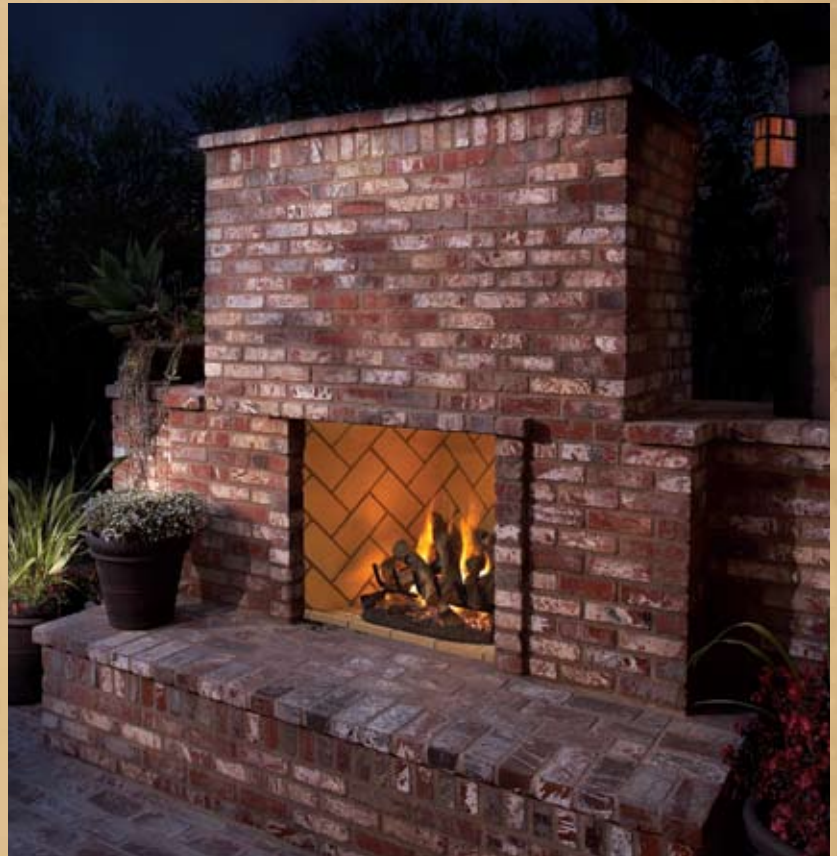

Options & Accessories

Choose from a variety of options to create a truly custom hearth.

- Optional brick panels are available in all standard sizes in Split Herringbone & Full Running Bond.
- The Masonry Chimney is available for indoor and outdoor installations in 14”.
- The optional arch is available in our 49” size and can be adjusted down to 44” and 39” sizes.



Split Herringbone



Full Running Bond



14” Masonry Chimney

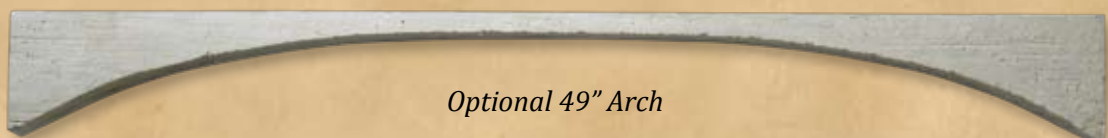

Optional 49” Arch

Wood Burning
Gas

Vented

Vent-Free

See-Thru

Indoor

Outdoor

New Construction

Retrofit

Existing

2nd Floor

Product Specifications

Fireplace Dimensions

MODEL	A	B	C	D	E	F	G
MM 33	37"	33"	23 1/4"	18 1/2"	21 3/4"	55"	12"
MM 39	43"	39"	30 1/4"	21 1/2"	27 3/4"	63 1/2"	12"
MM 44	48"	44"	35 1/4"	24"	32 3/4"	63 1/2"	12"
MM 49	53"	49"	40 1/4"	26 1/2"	37 3/4"	63 1/2"	12"
MM 63	67"	63"	53 1/4"	-----	46"	73"	2 x12"
MMST43	53"	43"	43"	-----	37 3/4"	65"	2 x12"

OPENING WIDTHS

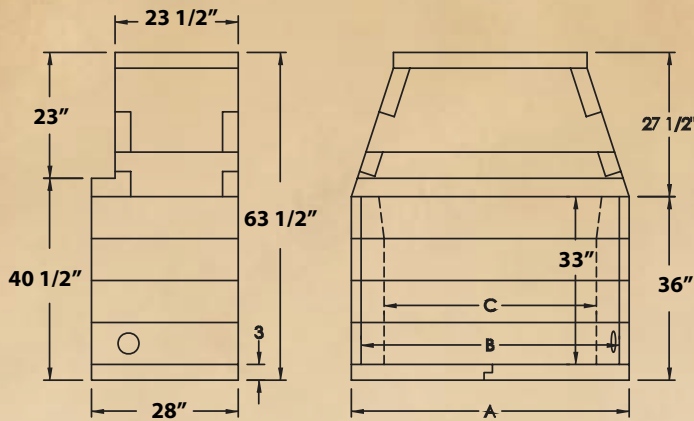
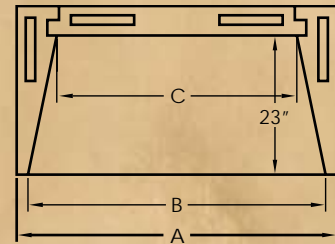

CONVENTIONAL

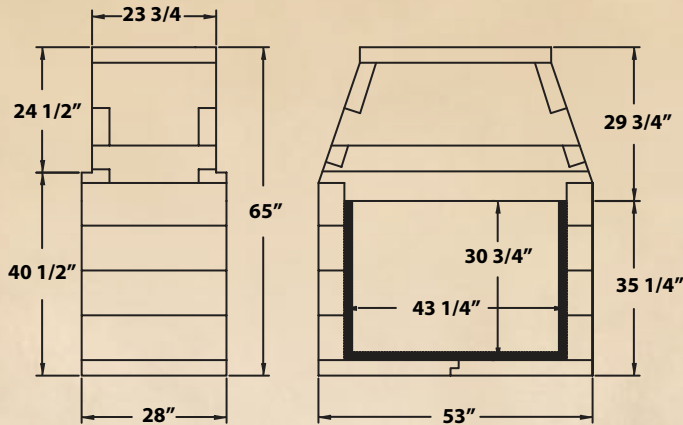

SEE THRU

TOP VIEWS

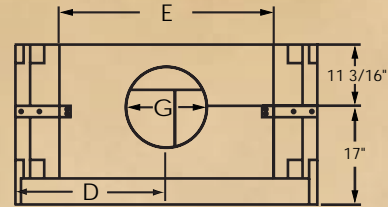

MM33 - MM49

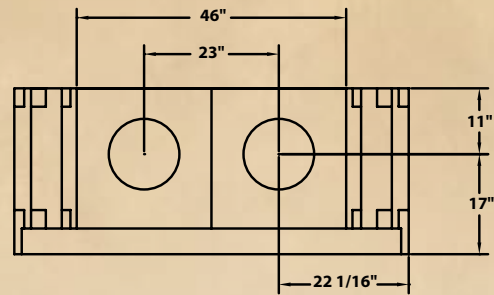

MM63

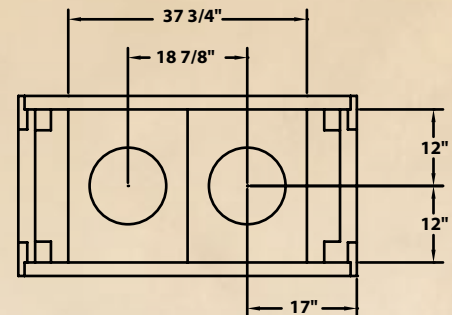

MMST43

Minimum Framing Dimensions

Fireplace	33"	39"	44"	49"	63"	ST43"
Height	57"	64"	64"	64"	74"	66"
Width	41"	47"	52"	57"	71"	57"
Depth	30"	30"	30"	30"	30"	28"



FMI PRODUCTS, LLC
www.fmiproducts.com
(866) 328-4537

© 2009 FMI PRODUCTS, LLC
FA 4200 1209

U.S. factory built & code compliant

